

**Andreas Fahl**  
**Medizintechnik-Vertrieb GmbH**  
 August-Horch-Str. 4a  
 51149 Köln - Germany  
 Phone +49 (0) 22 03/29 80-0  
 Fax +49 (0) 22 03/29 80-100  
 email [info@fahl.de](mailto:info@fahl.de)  
[www.fahl.de](http://www.fahl.de)

**Local branch Berlin**  
 Am Borsigturm 62  
 13507 Berlin - Germany  
 Phone +49 (0) 30/43 73 139-0  
 Fax +49 (0) 30/43 73 139-35

**Local branch Munich**  
 Aurbacher Straße 2  
 81541 München - Germany  
 Phone +49 (0) 89/58 90 90 9-0  
 Fax +49 (0) 89/58 90 90 9-20

**Blom-Singer®**

voice restoration systems

**Overseas branch Austria**  
 Triester Straße 14 / Bürohaus 2  
 2351 Wiener Neudorf - Austria  
 Phone +43 (0) 22 36/89 28 38-0  
 Fax +43 (0) 22 36/89 28 38-14

REF 90098-EN • Fb 2026 / 01 DOK FL BLOM-Singer® Voice Prosthesis Placement Surgical EN 01/2017

EUMed Sp. z o. o.  
 ul. Chłopickiego 50, 04-275 Warszawa  
 tel.: 022 879 69 20, fax: 022 879 69 28,  
 e-mail: [info@eumed.pl](mailto:info@eumed.pl) [www.eumed.pl](http://www.eumed.pl)

## BLOM-SINGER® VOICE PROSTHESIS PLACEMENT SURGICAL KIT

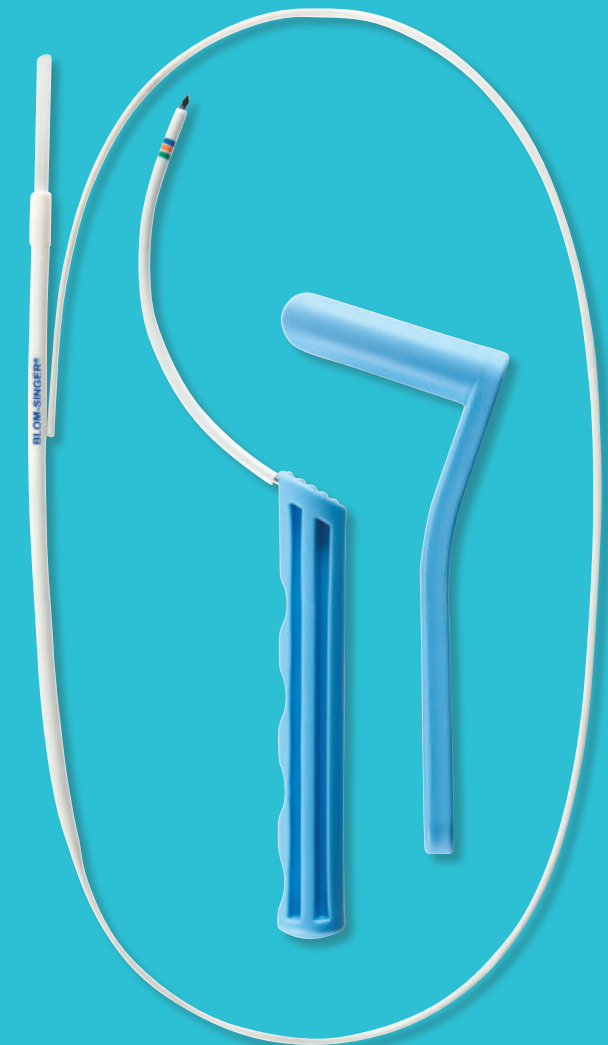

SET FOR INTRAOPERATIVE **PRIMARY** OR  
**SECONDARY PUNCTURE** FOR PLACEMENT  
 OF A BLOM-SINGER® VOICE PROSTHESIS

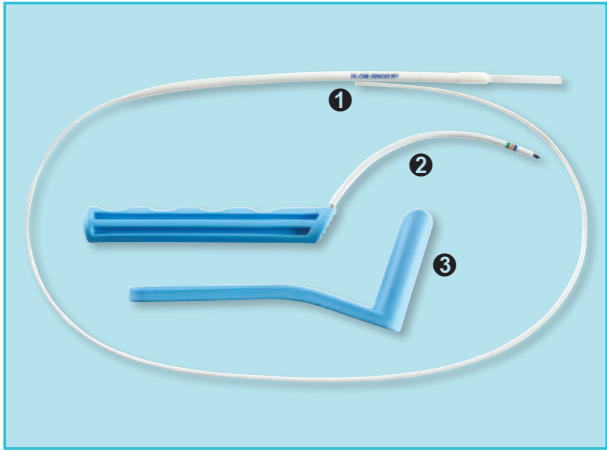

The surgical kit from Blom-Singer® is a complete surgical set for one-time use and serves for intraoperative primary or secondary puncturing for placement of a Blom-Singer® Classic™ Indwelling voice prosthesis. Besides the separately packaged voice prosthesis, it comprises the following components:

- ❶ **Guide catheter**
- ❷ **Trocar** (disposable instrument)
- ❸ **Pharynx protector** (disposable instrument)

**THE TROCAR - SURGICAL PUNCTURING & UNIQUE MEASURING OPTION**

The trocar included in the Voice Prosthesis Placement Surgical Kit is distinguished particularly by its tip which is extremely sharp-edged thanks to its 3-sided cut, thereby enabling effortless puncturing. Moreover, the trocar produces an extremely small puncture which is carefully dilated up with the aid of the enclosed guide catheter until the precise diameter of the voice prosthesis has been reached. This procedure is thus particularly gentle to the tissue and ensures good compatibility of voice prosthesis and puncture channel.

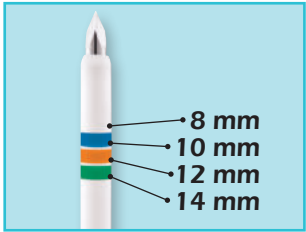

The trocar is seated in a sleeve that is furnished with a colour code. The colour code offers the unique possibility of measuring the length of the shunt channel already while performing the puncture and subsequently selecting the voice prosthesis that fits precisely. This is supplied in separate sterile packaging to be opened and used in accordance with the measurement result.

**QUICK AND EASY PREPARATION**

The surgical kit enables quick and easy preparation, particularly when connecting the voice prosthesis to the guide catheter.



1. A transparent loading sleeve with fenestration is located at the end of the guide catheter.



2. The sterile Blom-Singer® Classic™ Indwelling voice prosthesis is introduced through the fenestration with the safety thread first.



3. The voice prosthesis is then drawn further through the guide catheter by the safety thread,...



4. ...until the tracheal flange appears fully at the end of the guide catheter.

In this process, the prosthesis is drawn through from the tracheal to the oesophageal side, which, from the point of view of hygiene, is to be regarded as the optimal direction.

**PRIMARY PUNCTURE**

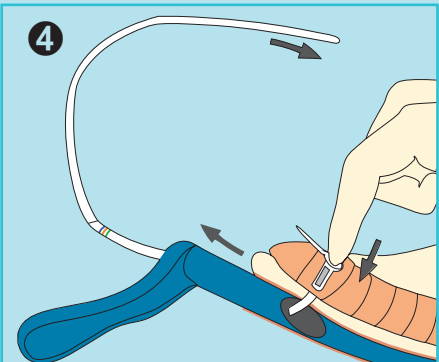
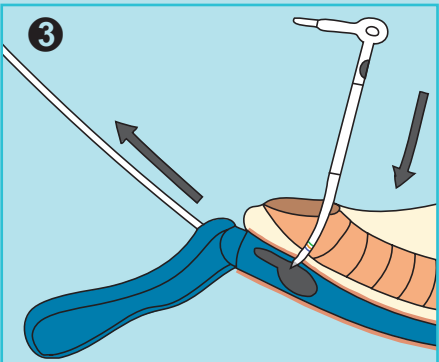
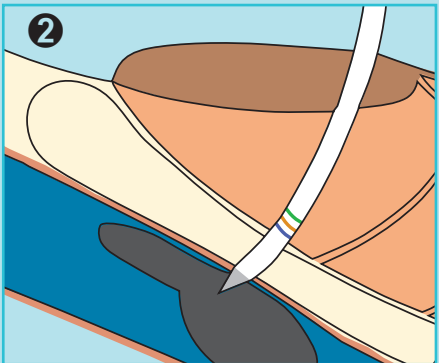
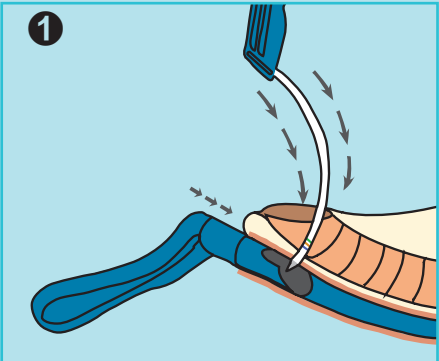

**SECONDARY PUNCTURE**

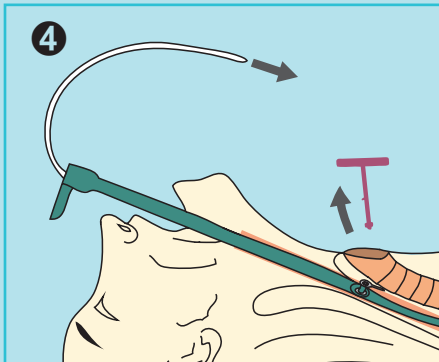
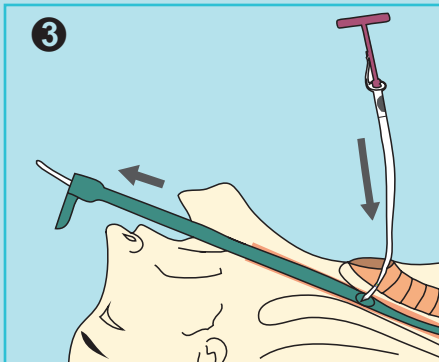
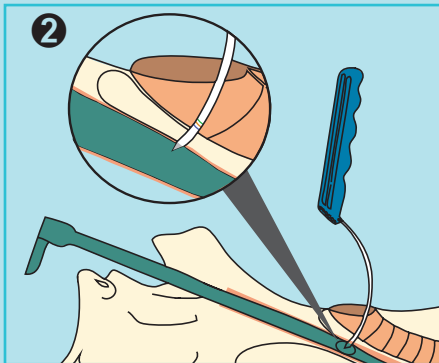
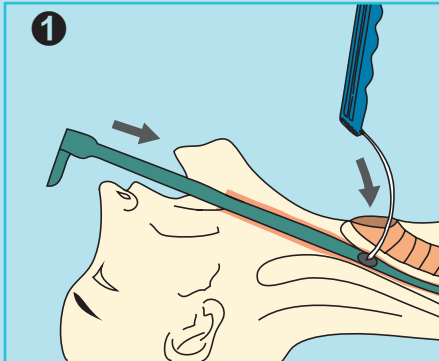

**ORDER INFORMATION:**

- **Blom-Singer® Voice Prosthesis Placement Surgical Kit, 16 Fr.**  
When ordering, please indicate the desired voice prosthesis size (8-14 mm)
- **Blom-Singer® Voice Prosthesis Placement Surgical Kit, 20 Fr.**  
When ordering, please indicate the desired voice prosthesis size (8-14 mm)

REF 28316

REF 28317